

AS BUILT CERTIFICATE

WE HEREBY CERTIFY THAT THE DRAWINGS SHOW THE ACTUAL LOCATION OF THE PUBLIC IMPROVEMENTS REQUIRED TO BE SHOWN THEREON. SAID IMPROVEMENTS INCLUDE ONLY STREET IMPROVEMENTS AND STORM SEWER.

SWORN BY:

TAYLOR CUSTOM HOMES
Robert S. Jones
 ROBERT S. JONES, P.E.

LOVELL - SAUERLAND AND ASSOC., INC.
Robert S. Jones 11/12/84
 ROBERT S. JONES, P.E.

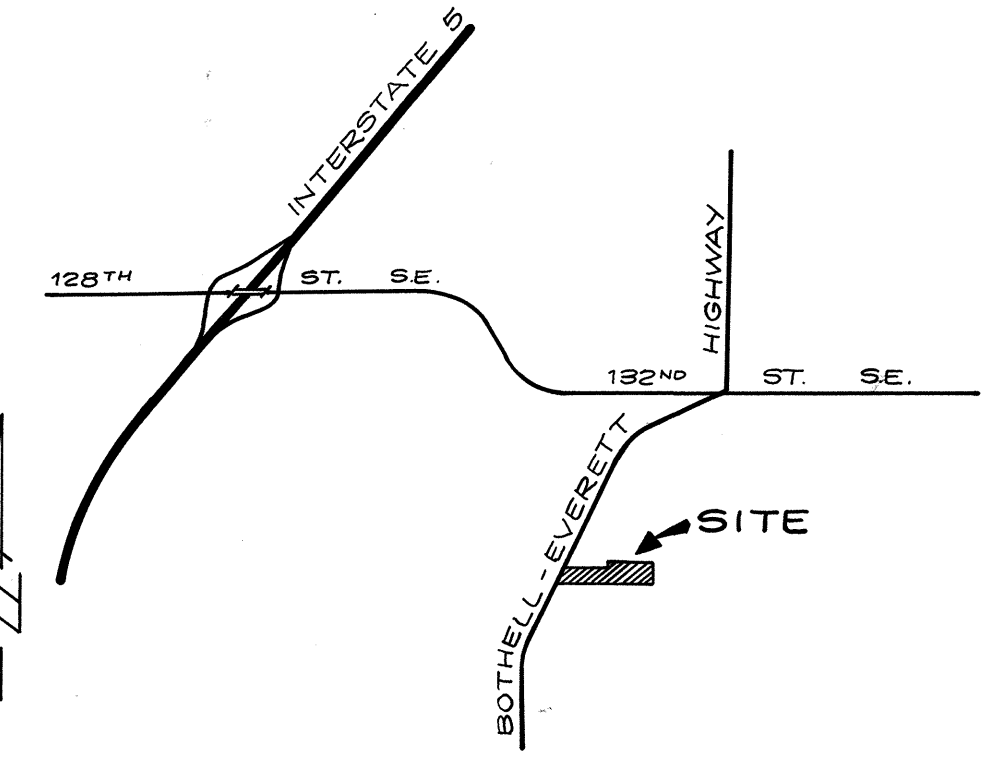

Approved for Construction *Lucretia Bay* for C.E. Wood 9/1/84

DEVELOPER

TAYLOR CUSTOM HOMES
 18904 HWY. 99, SUITE G
 LYNNWOOD, WA., 98036 PHONE: 771-5594

LEGEND

- + = SET CASSED MONUMENT
- o = SET CONCRETE MONUMENT

DATUM: SILVER LAKE WATER DISTRICT
BENCH MARK: RR SPIKE IN POWER POLE @ NE COR. OF VILLAGE GREEN DRIVE & BOTHELL-EVERETT HIGHWAY
 ELEV. 416.00



ROAD AND STORM DRAINAGE PLAN FOR THE VILLAGE GREEN
 IN SW1/4 OF NE 1/4, SECTION 31, T. 28 N., R. 5 E., W. M.
 SNOHOMISH COUNTY, WASHINGTON

2	AS - BUILT	11-8-84	TVC
1	PER COUNTY REVIEW	5-22-84	RCN
Lovell-Sauerland & Associates, Inc.			
SURVEYORS • DEVELOPMENT CONSULTANTS • PLANNERS			
23106 100TH AVE. W. • EDMONDS WA. 98020 • PHONE 775-1591			
DRAWN	CHECKED	DATE	FILE NO.
RCN	RSJ	11-30-83	83-1062

HDEV-469

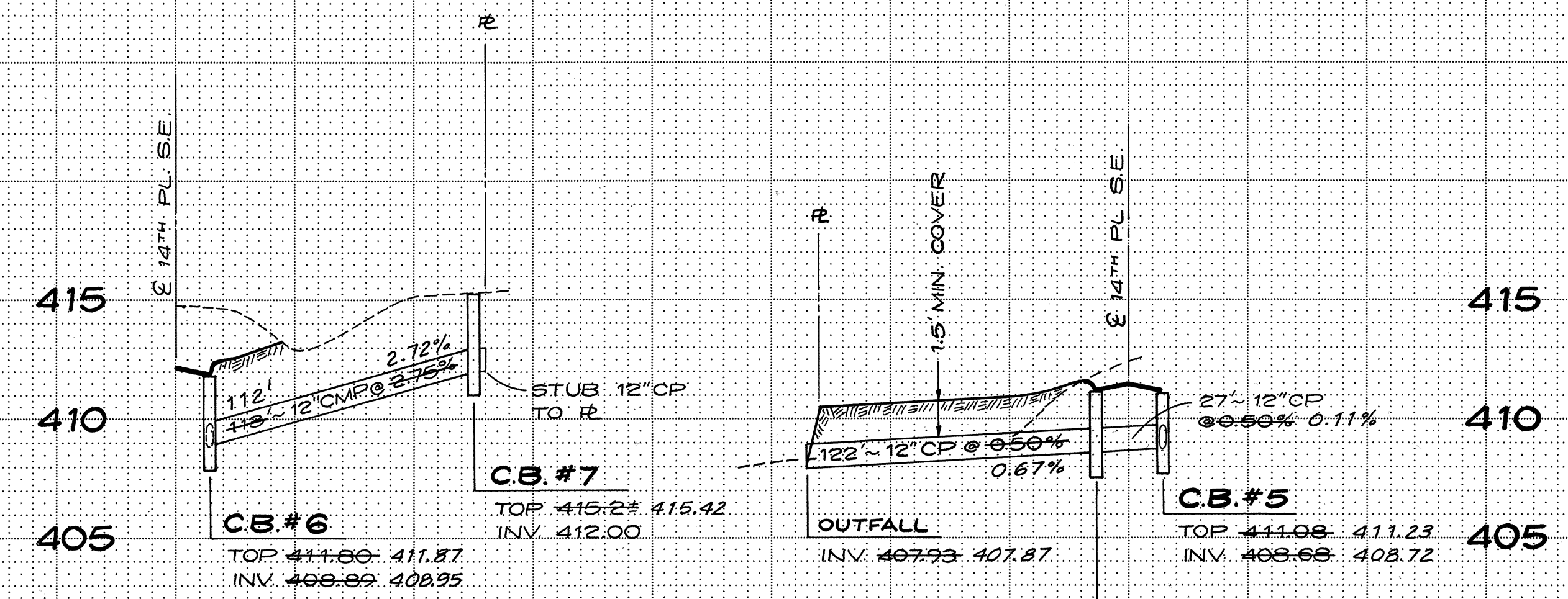
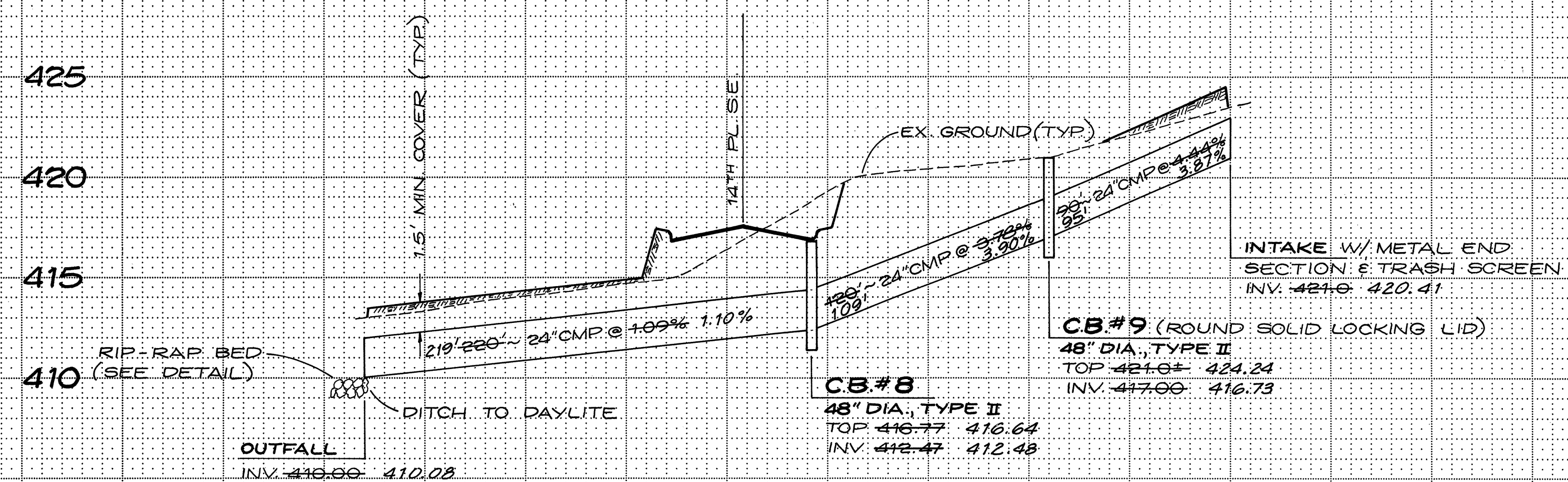
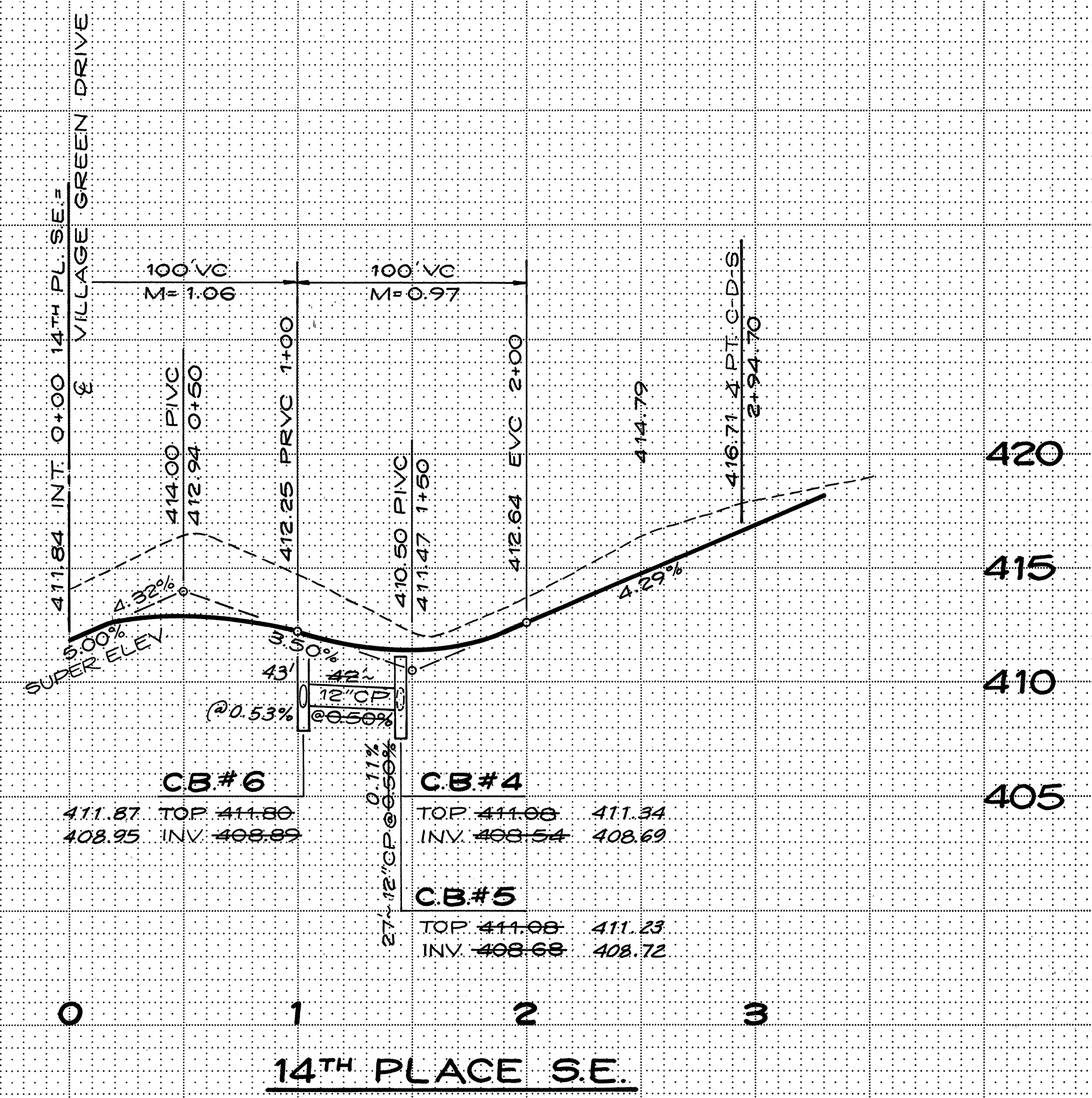
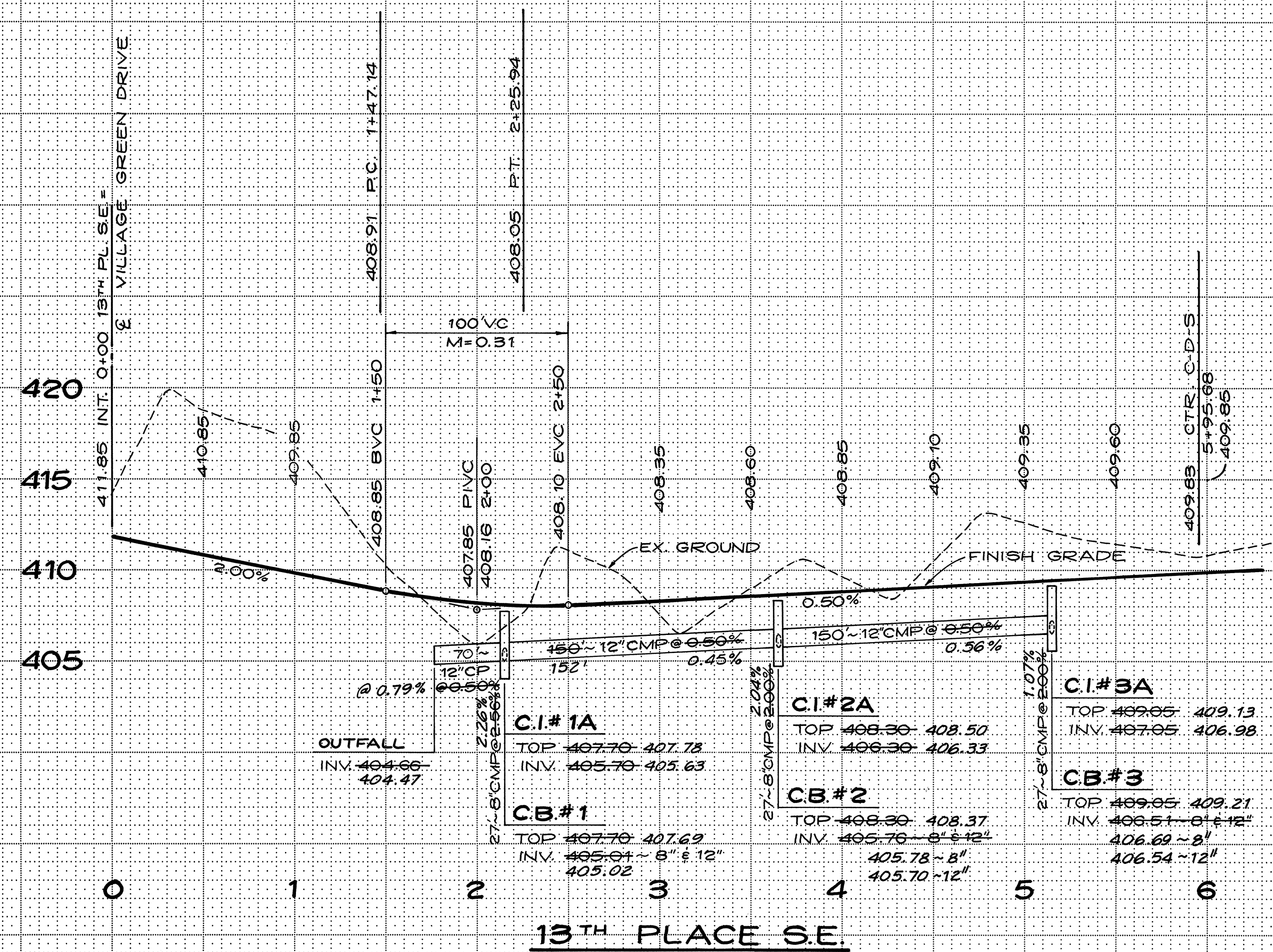

ESM'T LOTS 17, 18 & 21, 22

ESM'T LOTS 24 & 25

ESM'T LOTS 15 & 16

ROAD AND STORM DRAINAGE PROFILES
FOR
THE VILLAGE GREEN
IN SW1/4 OF NE 1/4, SECTION 31, T. 28 N., R. 5 E., W.M.
SNOHOMISH COUNTY, WASHINGTON



2	AS-BUILT	11-8-84	T.V.G.
1	PER COUNTY REVIEW	5-22-84	RCN
Lovell-Sauerland & Associates, Inc.			
SURVEYORS • DEVELOPMENT CONSULTANTS • PLANNERS 23106 100TH AVE. W. • EDMONDS WA. 98020 • PHONE 775-1591			
DRAWN	CHECKED	DATE	F.B.
RCN	RSJ	11-30-83	191
SCALE		FILE NO.	
1"=5' VERT. 1"=50' HOR.		83-1062	

THE VILLAGE GREEN

HDEV-470

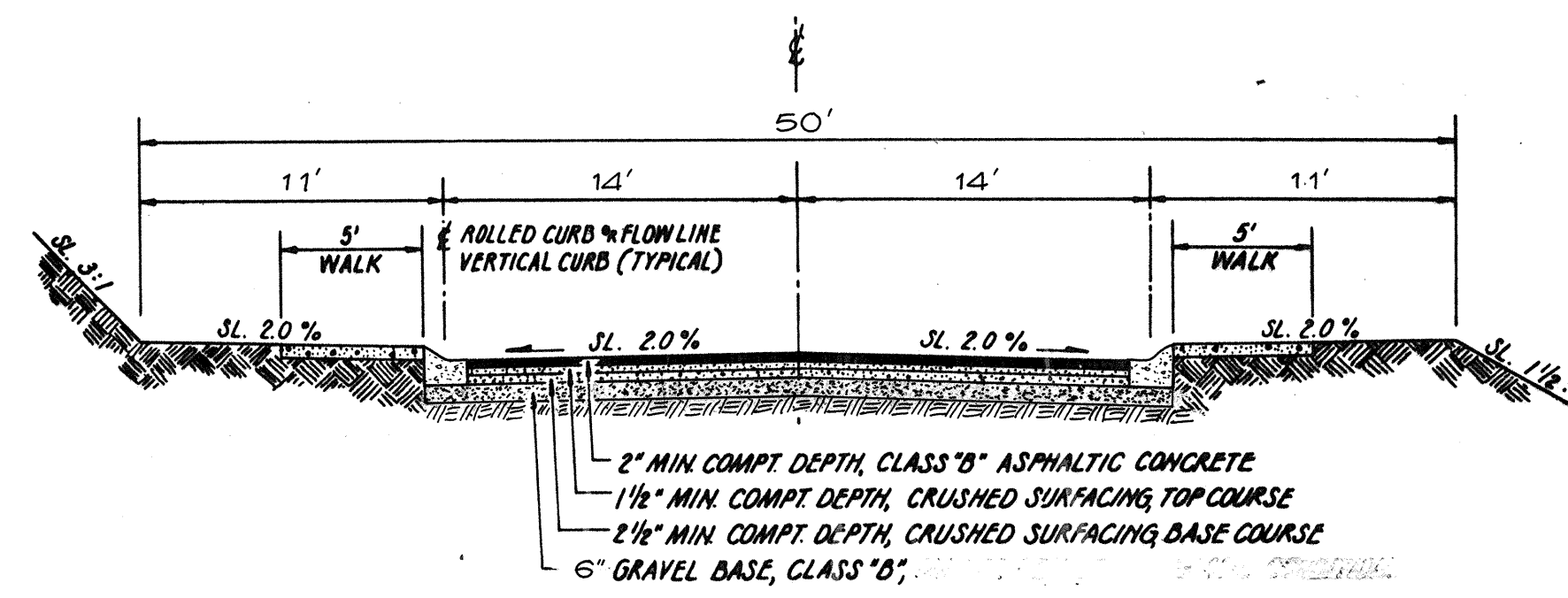
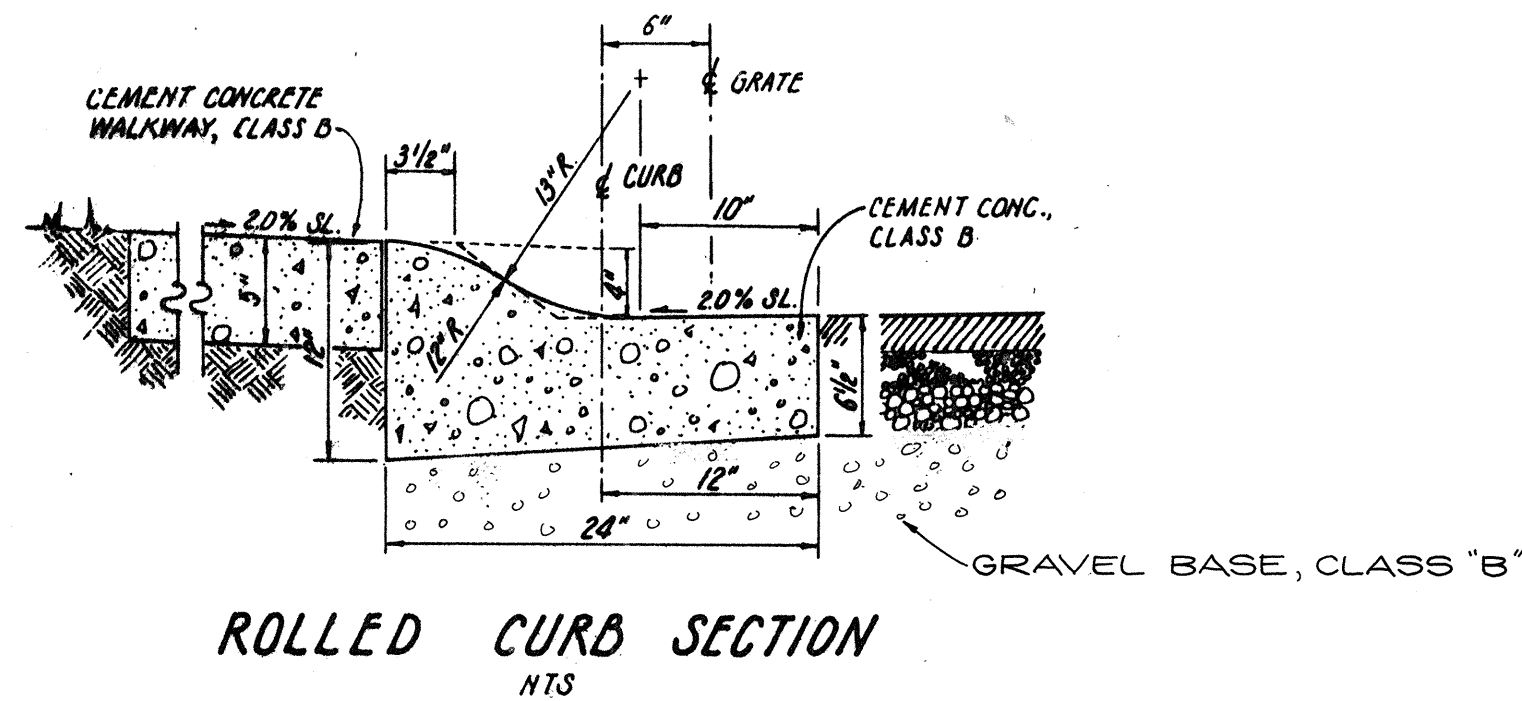

TYPICAL ROADWAY SECTION
NTS
NOTE: SIDEWALK ONE SIDE ONLY ON 14TH PL. SE.

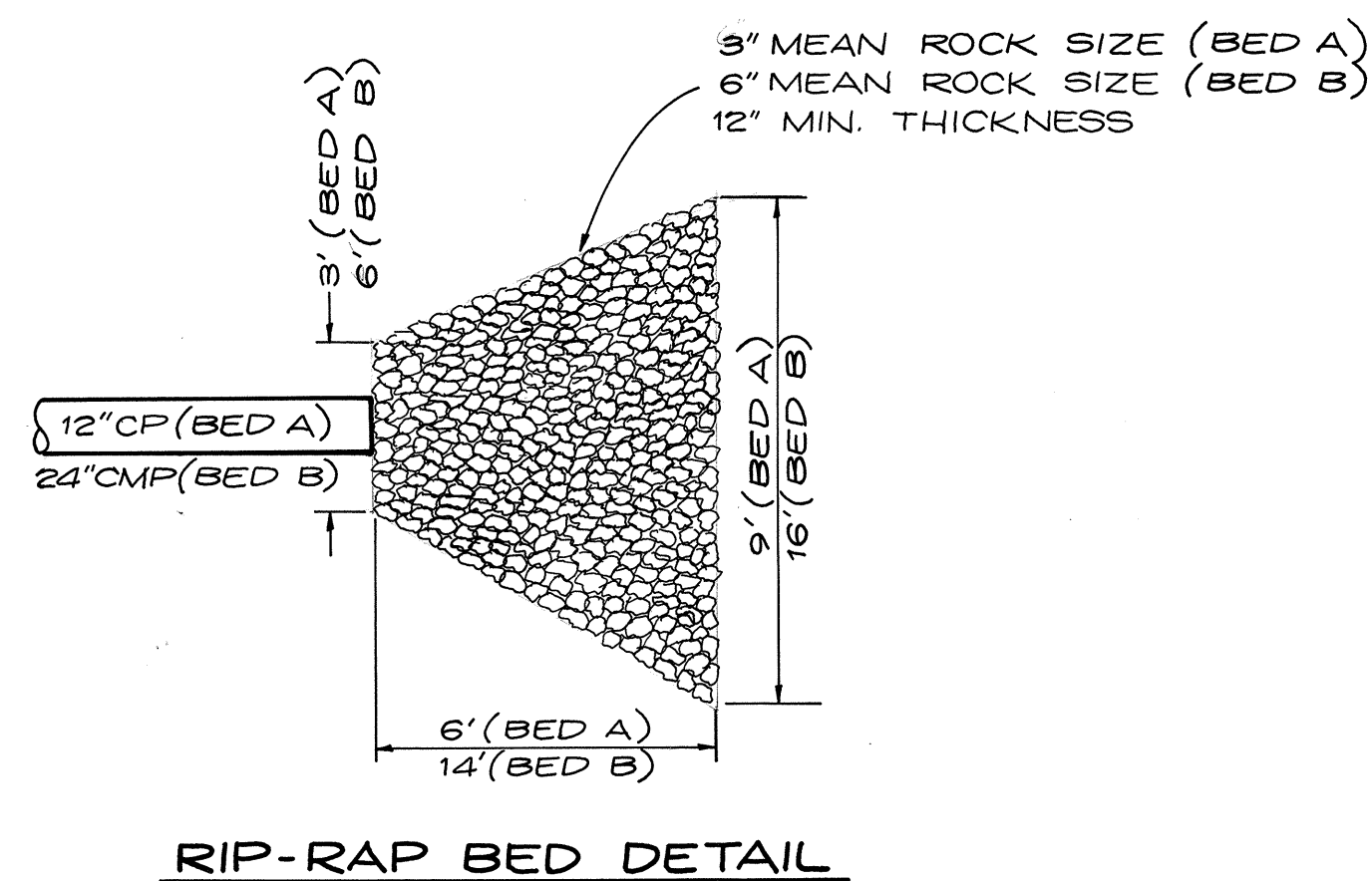

GENERAL NOTES

1. ALL WORK AND MATERIALS SHALL BE IN ACCORDANCE WITH SNOHOMISH COUNTY STANDARDS AND SPECIFICATIONS.
2. LOCATIONS OF EXISTING UTILITIES AND IMPROVEMENTS SHOWN ARE APPROXIMATE ONLY AND IT SHALL BE THE RESPONSIBILITY OF THE CONTRACTOR TO DETERMINE THE EXACT LOCATION(S) OF ALL UTILITIES AND IMPROVEMENTS TO AVOID DAMAGE OR DISTURBANCE.
3. ALL WORK WITHIN THE PLAT AND COUNTY RIGHT OF WAY SHALL BE SUBJECT TO THE INSPECTION OF THE ENGINEER.
4. PRIOR TO ANY SITE WORK, THE CONTRACTOR SHALL CONTACT THE FIELD COORDINATOR FOR PLATS, UTILITIES AND DRAINAGE, AT 259-9464, TO ARRANGE FOR THE REQUIRED INSPECTIONS.
5. ALL SITE WORK OUTSIDE COUNTY RIGHT OF WAY MUST COMPLY TO CHAPTER 70 OF THE BUILDING CODE.
6. THE CONTRACTOR SHALL BE RESPONSIBLE FOR OBTAINING ALL PERMITS FOR ROAD AND UTILITY CONSTRUCTION.
7. THE TEMPORARY EROSION/SEDIMENTATION CONTROL FACILITY SHALL BE CONSTRUCTED PRIOR TO ANY GRADING OR EXTENSIVE LAND CLEARING IN ACCORDANCE WITH THE APPROVED TEMPORARY EROSION/SEDIMENTATION CONTROL PLAN. THESE FACILITIES MUST BE SATISFACTORILY MAINTAINED UNTIL CONSTRUCTION AND LANDSCAPING IS COMPLETED AND THE POTENTIAL FOR ONSITE EROSION HAS PASSED.
8. ALL STORM SEWER PIPE SHALL BE CONCRETE, NON-REINFORCED, ASTM C-14, OR CORRUGATED METAL 16 GA. GALVANIZED AND ASPHALT COATED TREATMENT 1 OR BETTER, OR CORRUGATED ALUMINUM PIPE, 16 GA. OR AASHTO M274-79 ALUMINIZED STEEL.
9. ALL PIPE SHALL BE PLACED ON STABLE EARTH, OR IF IN THE OPINION OF THE ENGINEER, THE EXISTING FOUNDATION IS UNSATISFACTORY, THEN IT SHALL BE EXCAVATED BELOW GRADE AND BACKFILLED TO GRADE WITH SAND-GRAVEL, CRUSHED STONE OR OTHER SUITABLE MATERIAL. NEVER INSTALL PIPE ON SOD, FROZEN EARTH OR LARGE BOULDERS OR ROCK.
10. THE BACKFILL SHALL BE PLACED EQUALLY ON BOTH SIDES OF THE PIPE OR PIPE-ARCH IN LAYERS WITH A LOOSE AVERAGE DEPTH OF 6", MAX. DEPTH 8", THOROUGHLY TAMPING EACH LAYER. THESE COMPACTED LAYERS MUST EXTEND FOR ONE DIAMETER ON EACH SIDE OF THE PIPE OR TO THE SIDE OF THE TRENCH. MATERIALS TO COMPLETE THE FILL OVER PIPE SHALL BE THE SAME AS DESCRIBED.
11. ALL DISTURBED SLOPES SHALL BE SEEDED WITH A PERENNIAL GROUND COVER (GRASS) TO PREVENT EROSION.
12. ALL GRATES (INLET) SHALL BE DEPRESSED 0.1 FEET BELOW PAVEMENT LEVEL.
13. ALL CATCH BASINS TO BE TYPE 1 UNLESS OTHERWISE NOTED.
14. THE CONTRACTOR SHALL BE RESPONSIBLE FOR ADJUSTING ALL MANHOLE, INLET, AND CATCH BASIN FRAMES AND GRATES JUST PRIOR TO POURING OF CURBS.
15. ALL CATCH BASINS WITH A DEPTH OVER 5.0 FEET TO THE FLOWLINE SHALL BE TYPE II CB'S (MANHOLE).
16. MAILBOXES SHALL BE CONSTRUCTED TO SNOHOMISH COUNTY STANDARDS. (SEE SNOHOMISH COUNTY STANDARD DRAWING NO. B-7).
17. ALL FILLS SHALL BE COMPACTED TO A MINIMUM OF 95% OF MAXIMUM DENSITY.
18. CP INDICATES CONCRETE PIPE WILL BE REQUIRED; CMP INDICATES CORRUGATED METAL PIPE MAY BE USED INSTEAD OF CONCRETE PIPE.
19. PRIOR TO SIDEWALK CONSTRUCTION, THE ENGINEER WILL EVALUATE INDIVIDUAL LOT DRAINAGE AND DIRECT THE INSTALLATION OF CATCH BASIN STUB OUTS AND PERFORATED PIPE AS REQUIRED. LOCATIONS FOR THESE INSTALLATIONS SHALL BE PLACED ON THE AS-BUILT CONSTRUCTION PLANS AND SUBMITTED TO THE COUNTY.

DETAILS
FOR
THE VILLAGE GREEN
IN SW1/4 OF NE1/4, SECTION 31, T.28 N., R.5 E., W.M.
SNOHOMISH COUNTY, WASHINGTON

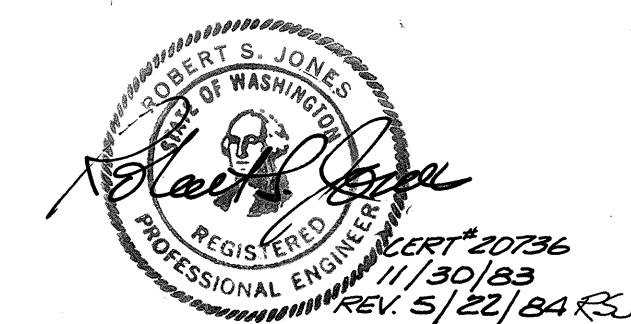

PER COUNTY REVIEW		5-22-84		RCN	
Lovell-Sauerland & Associates, Inc. SURVEYORS • DEVELOPMENT CONSULTANTS • PLANNERS 23106 100TH AVE. W. • EDMONDS WA 98020 • PHONE 775-1591					
DRAWN	CHECKED	DATE	F.B.	SCALE	FILE NO.
RCN	RSJ	11-30-83	191	NONE	83-1062

HDEV-471

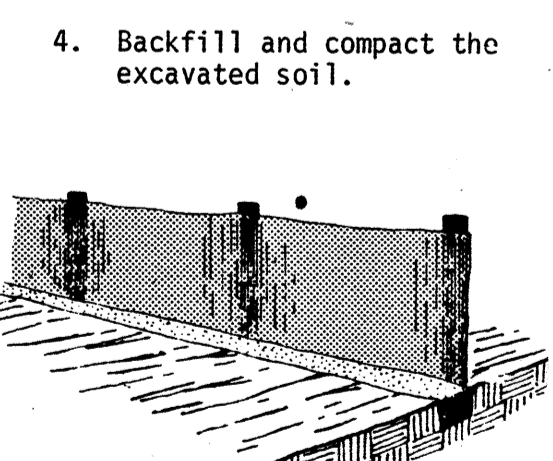
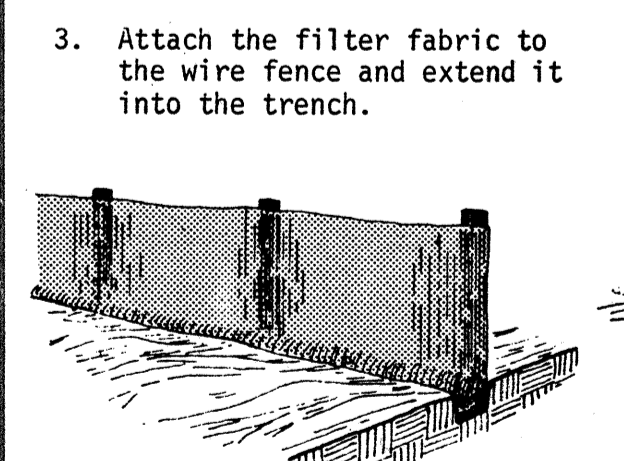
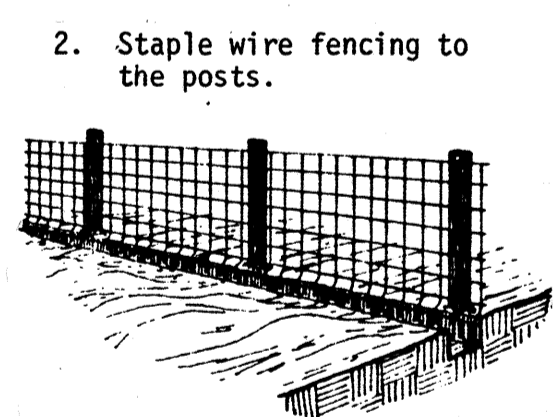
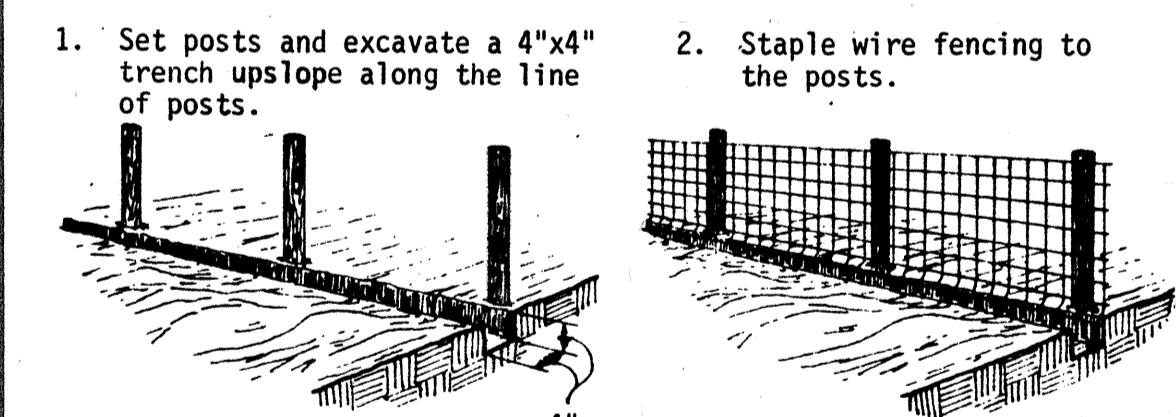
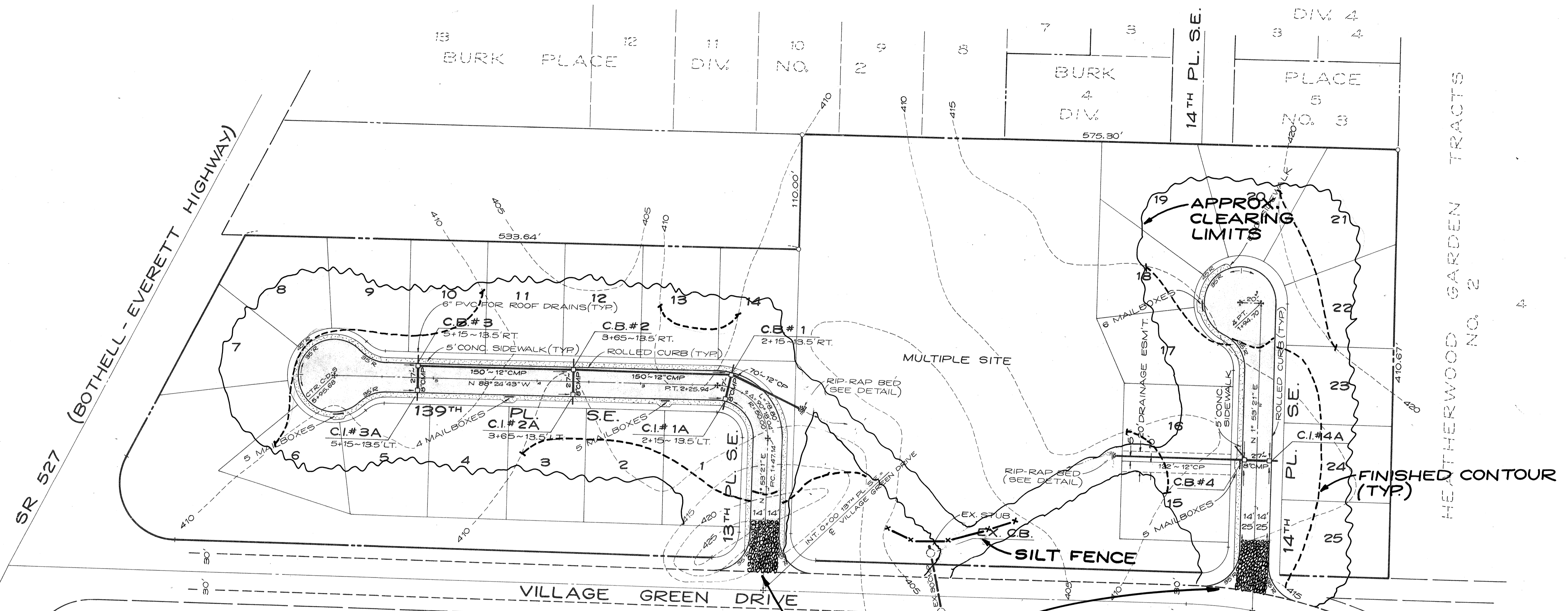

Extension of fabric and wire into the trench.

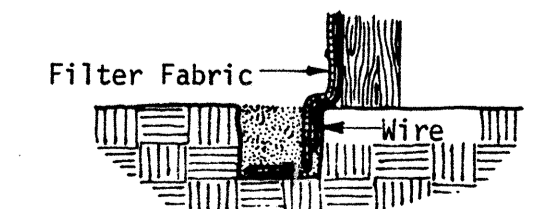

CONSTRUCTION OF A SILT FENCE

Silt Fence: This sediment barrier utilizes standard strength or extra strength synthetic filter fabrics. It is designed for situations in which only sheet or overland flows are expected. See Plate 1.06c.

- The height of a silt fence shall not exceed 36 inches (higher fences may impound volumes of water sufficient to cause failure of the structure).
- The filter fabric shall be purchased in a continuous roll cut to the length of the barrier to avoid the use of joints. When joints are necessary, filter cloth shall be spliced together only at a support post, with a minimum 6-inch overlap, and securely sealed.
- Posts shall be spaced a maximum of 10 feet apart at the barrier location and driven securely into the ground (minimum of 12 inches). When extra strength fabric is used without the wire support fence, post spacing shall not exceed 6 feet.
- A trench shall be excavated approximately 4 inches wide and 4 inches deep along the line of posts and upslope from the barrier.
- When standard strength filter fabric is used, a wire mesh support fence shall be fastened securely to the upslope side of the posts using heavy duty wire staples at least 1 inch long, tie wires or hog rings. The wire shall extend into the trench a minimum of 2 inches and shall not extend more than 36 inches above the original ground surface.
- The Standard Strength filter fabric shall be stapled or wired to the fence, and 8 inches of the fabric shall be extended into the trench. The fabric shall not extend more than 36 inches above the original ground surface. Filter fabric shall not be stapled to existing trees.
- When extra strength filter fabric and closer post spacing are used, the wire mesh support fence may be eliminated. In such a case, the filter fabric is stapled or wired directly to the posts with all other provisions of item No. 6 applying.
- The trench shall be backfilled and the soil compacted over the filter fabric.
- Silt fences shall be removed when they have served their useful purpose, but not before the upslope area has been permanently stabilized.

Maintenance

- Silt fences and filter barriers shall be inspected immediately after each rainfall and at least daily during prolonged rainfall. Any required repairs shall be made immediately.
- Should the fabric on a silt fence or filter barrier decompose or become ineffective prior to the end of the expected usable life and the barrier still be necessary, the fabric shall be replaced promptly.
- Sediment deposits should be removed after each storm event. They must be removed when deposits reach approximately one-half the height of the barrier.
- Any sediment deposits remaining in place after the silt fence or filter barrier is no longer required shall be dressed to conform with the existing grade, prepared and seeded.

TEMPORARY CONSTRUCTION ENTRANCE
 (50' LONG, 28' WIDE, 6" DEEP)
 PLACE @ EDGE OF EX. ASPHALT,
 V.D.H. & T COARSE AGGREGATE NO. 1 (2-3 INCH STONE)
 TO BE USED OR EQUAL

MAINTENANCE

THE ENTRANCE SHALL BE MAINTAINED IN A CONDITION WHICH WILL PREVENT TRACKING OR FLOW OF MUD ONTO PUBLIC RIGHTS-OF-WAY. THIS MAY REQUIRE PERIODIC TOP DRESSING WITH 2-INCH STONE, AS CONDITIONS DEMAND, AND REPAIR AND/OR CLEANOUT OF ANY STRUCTURES USED TO TRAP SEDIMENT. ALL MATERIALS SPILLED, DROPPED, WASHED OR TRACKED FROM VEHICLES ONTO ROADWAYS OR INTO STORM DRAINS MUST BE REMOVED IMMEDIATELY.

T.E. & S.C. PLAN
 FOR
THE VILLAGE GREEN
 IN SW 1/4 OF NE 1/4, SECTION 31, T. 28 N., R. 5 E., W.M.
 SNOHOMISH COUNTY, WASHINGTON

Approved for Construction *Robert L. Berg* for C.E. Wood 4/1/84

DATUM: SILVER LAKE WATER DISTRICT
 BENCH MARK: R.R. SPIKE IN POWER POLE
 @ N.E. COR. OF VILLAGE GREEN DRIVE &
 BOTHELL - EVERETT HIGHWAY
 ELEV. 416.00

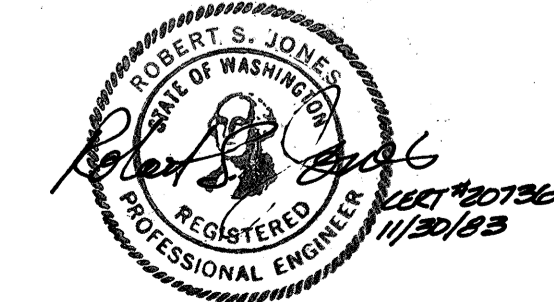

Lovell-Sauerland & Associates, Inc. SURVEYORS • DEVELOPMENT CONSULTANTS • PLANNERS 23106 100TH AVE. W. • EDMONDS WA. 98020 • PHONE 775-1591					
DRAWN RCN	CHECKED RSJ	DATE 11-30-83	F.B. 191	SCALE 1"=50'	FILE NO. 83-1062

THE VILLAGE GREEN

HDEV-472

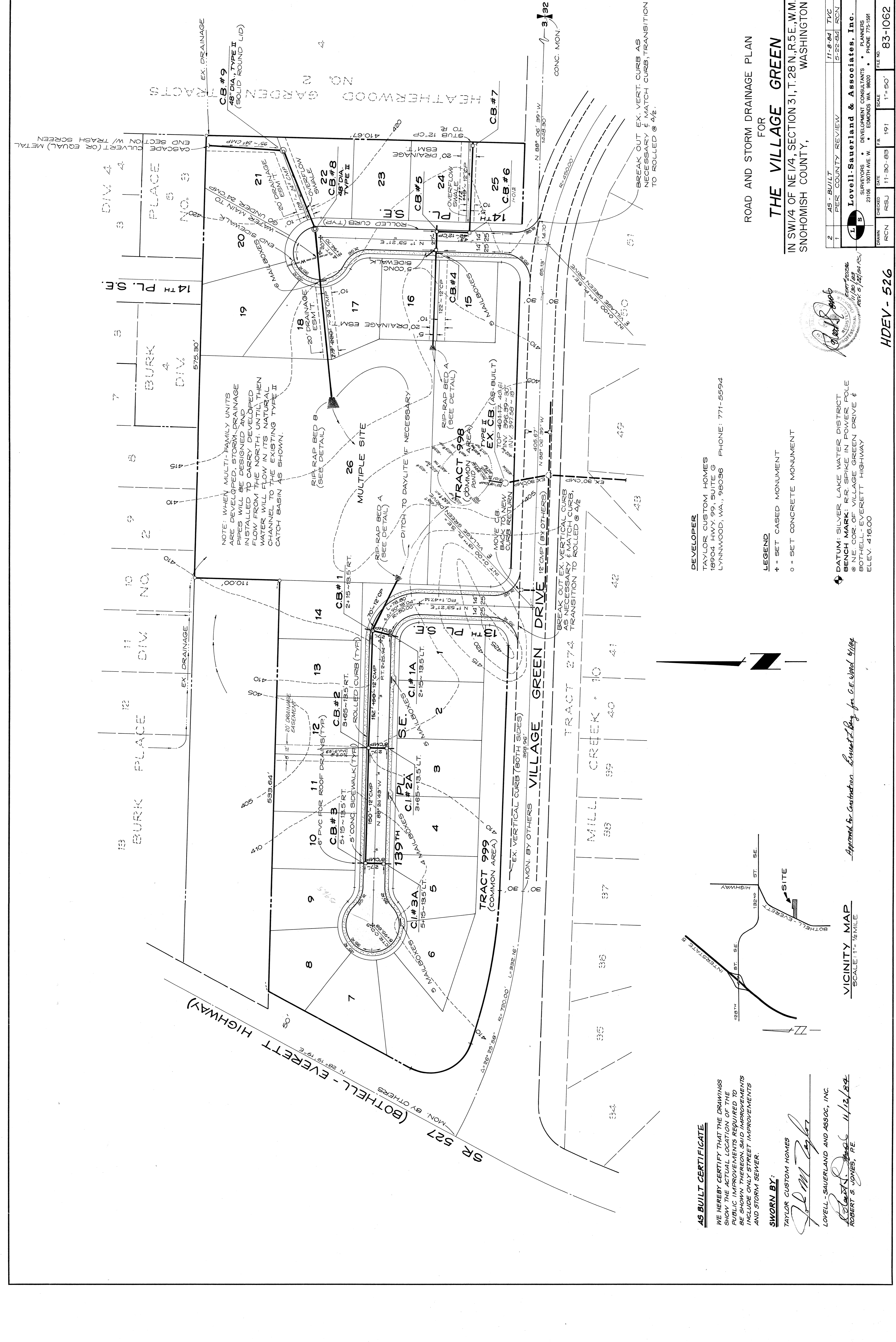

AS BUILT CERTIFICATE

WE HEREBY CERTIFY THAT THE DRAWINGS SHOW THE ACTUAL LOCATION OF THE PUBLIC IMPROVEMENTS REQUIRED TO BE SHOWN THEREON. SAID IMPROVEMENTS INCLUDE ONLY STREET IMPROVEMENTS AND STORM SEWER.

SWORN BY:

TAYLOR CUSTOM HOMES

[Signature]
LOVELL SAUERLAND AND ASSOC., INC.

Approved for Construction *[Signature]* for G.E. dated 6/1/84
ROBERT S. JONES, P.E. 11/12/84

VICINITY MAP

SCALE: 1" = 1/2 MILE

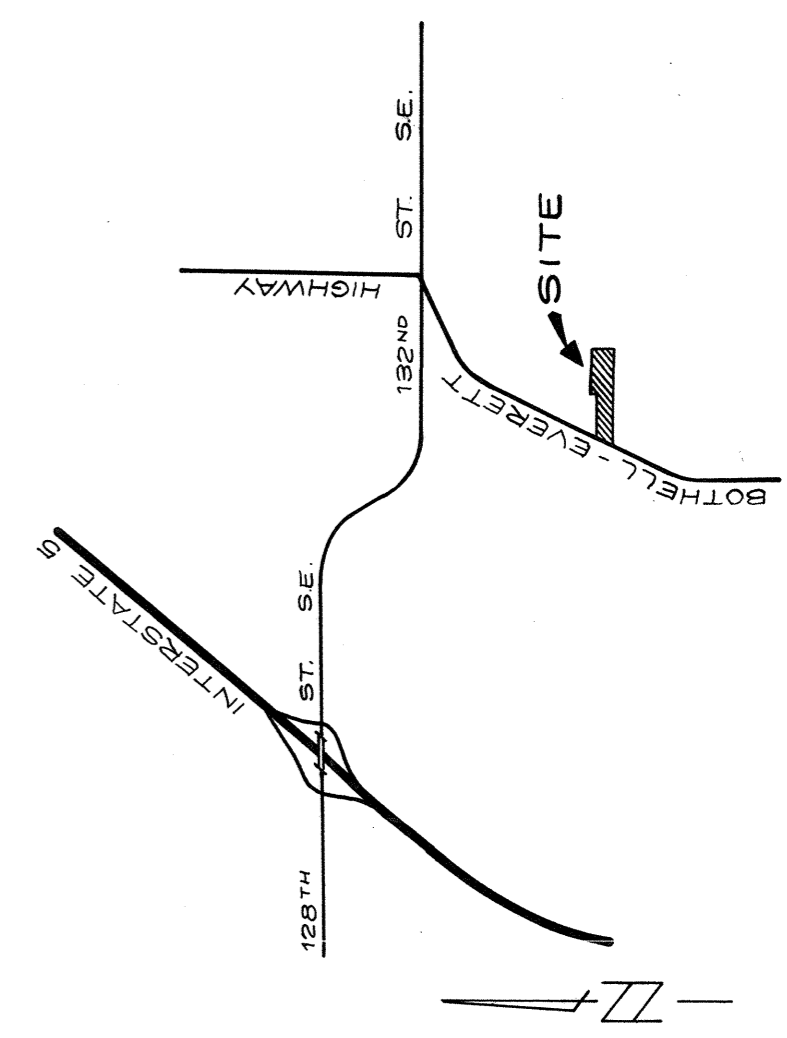

FOR ROAD AND STORM DRAINAGE PLAN

THE VILLAGE GREEN

IN SW 1/4 OF NE 1/4, SECTION 31, T. 28 N. R. 5E. W.M. SNOHOMISH COUNTY, WASHINGTON

2	45 - BUILT	PER COUNTY REVIEW	11-8-84	TVC
1	AS - BUILT	PER COUNTY REVIEW	5-22-84	RCN
DRAWN	RCN	CHECKED	DATE	SCALE
FILE NO.	191	11-30-83	1" = 50'	83-1062

HDEV - 526

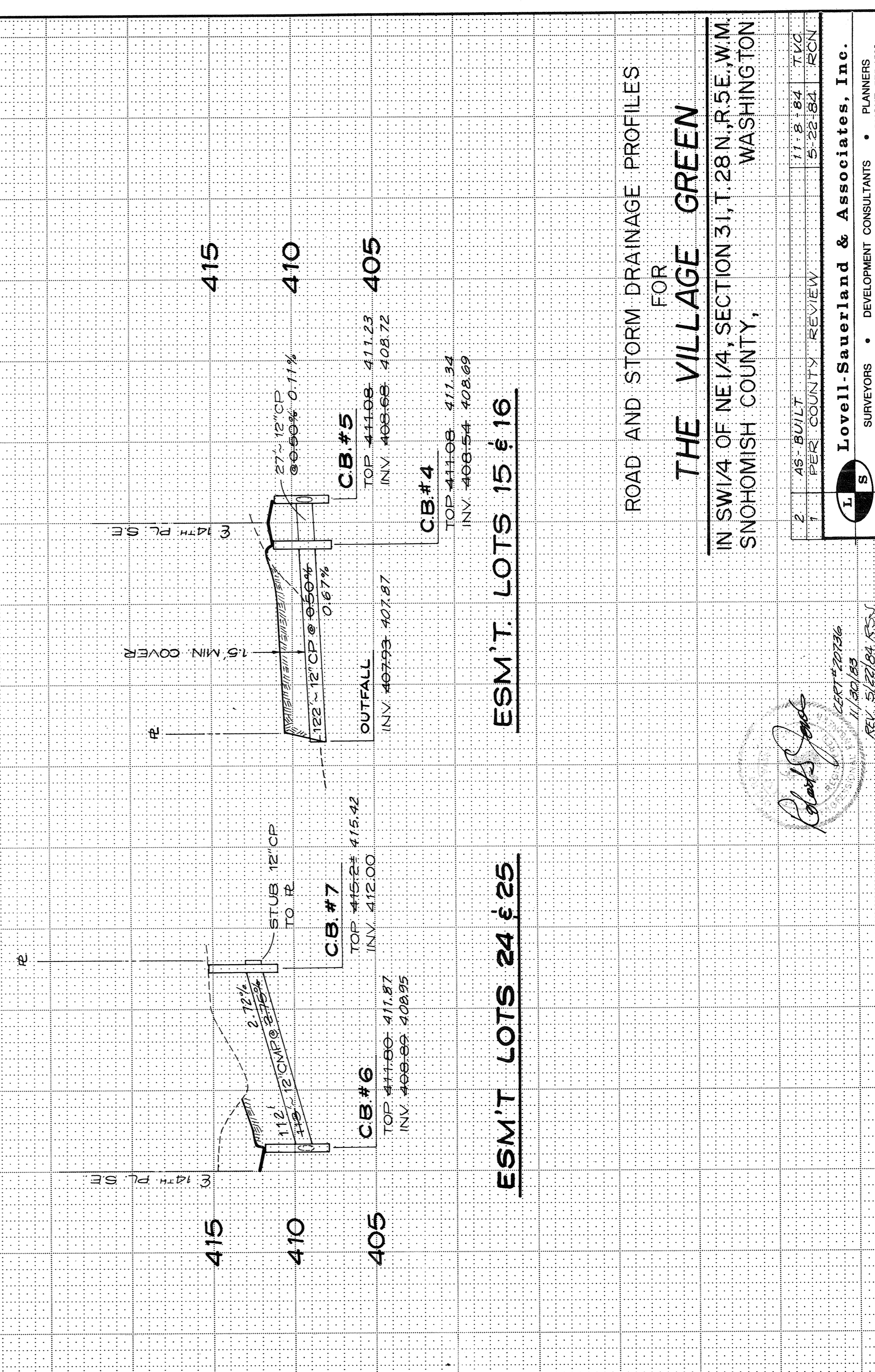
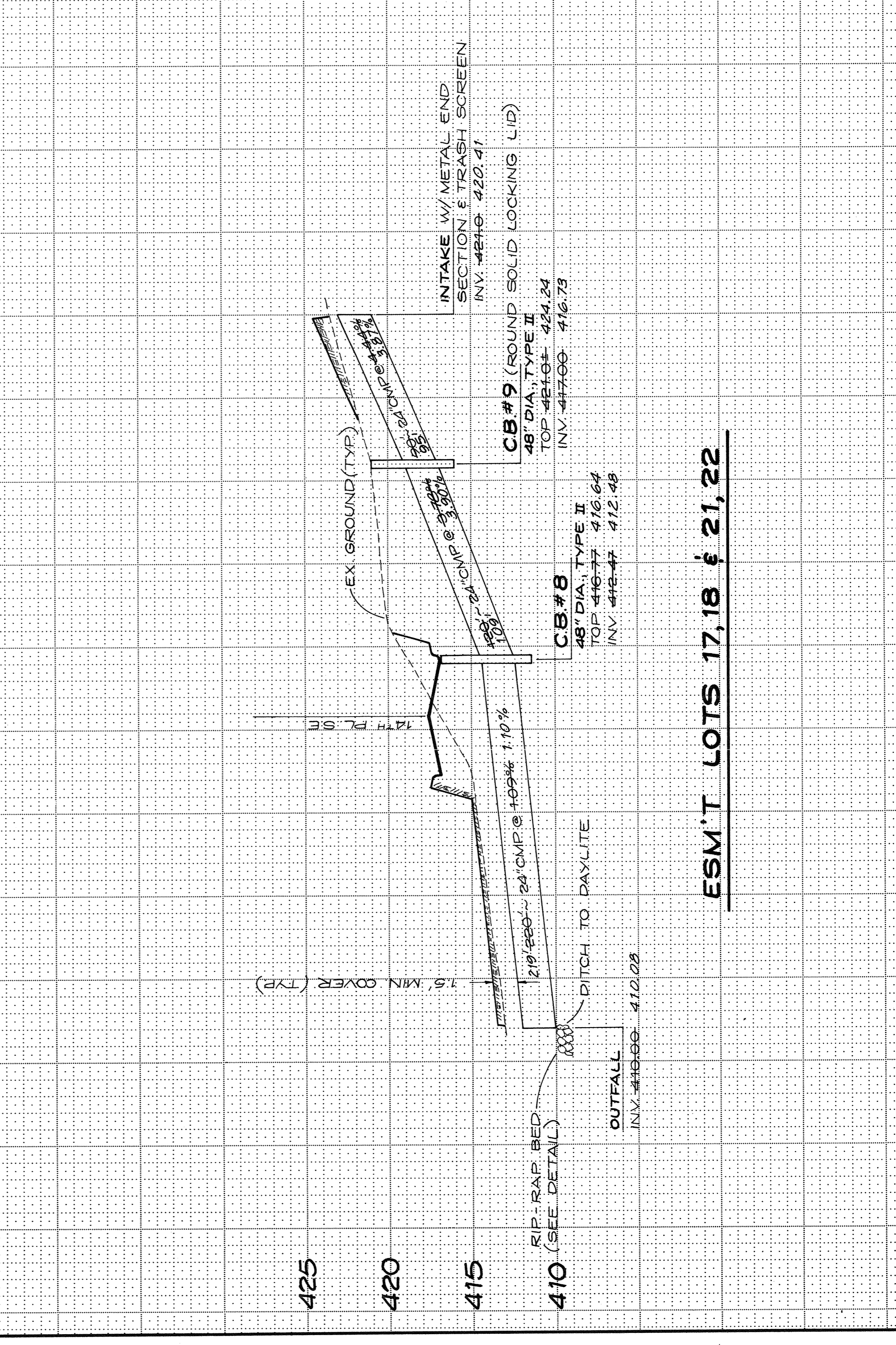
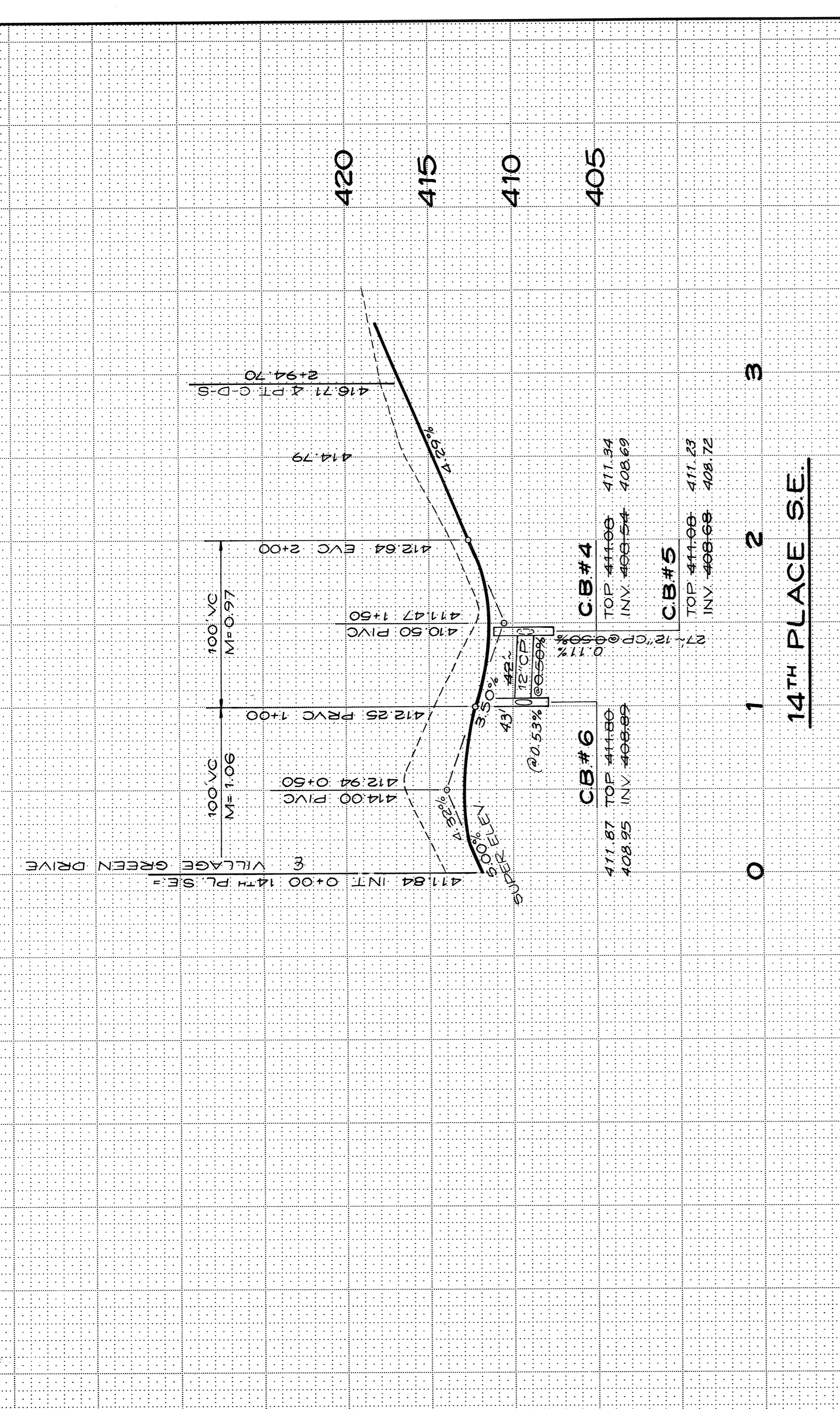
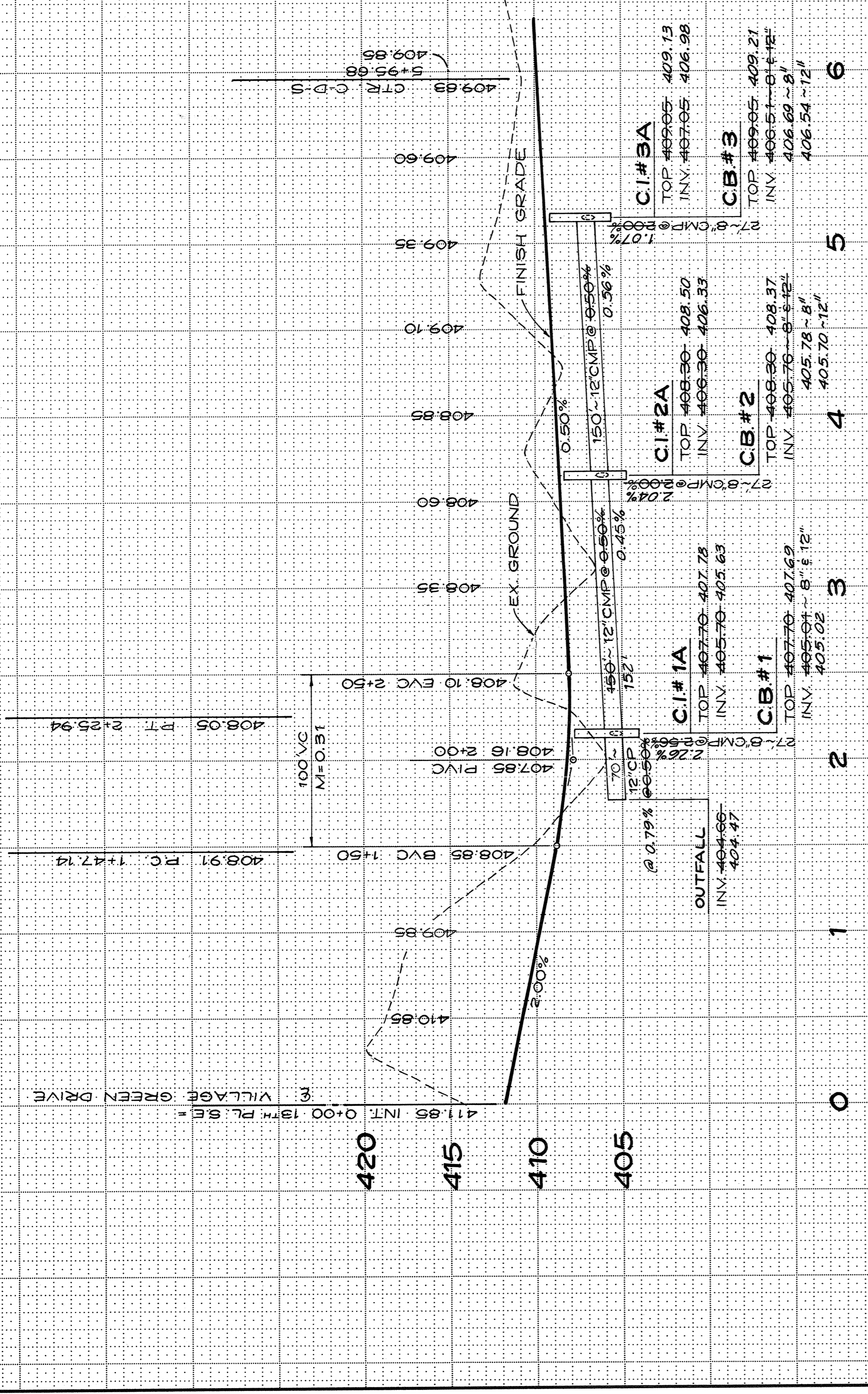

ROAD AND STORM DRAINAGE PROFILES
FOR
THE VILLAGE GREEN
IN SW1/4 OF NE1/4, SECTION 31, T.28N., R.5E., W.M.
SNOHOMISH COUNTY,

Lovell-Sauerland & Associates, Inc.
SURVEYORS • DEVELOPMENT CONSULTANTS • PLANNERS
23106 100TH AVE. N. • EDMONDS, WA 98020 • PHONE 775-1581

DATE: 11-30-03
DRAWN: RSJ
CHECKED: RSJ
SCALE: VERT. 1"=50' HOR. 1"=50'

FILE NO: 83-1062
SHEET 2 OF 3

Charles Jones
11/30/03
REV. 5/27/04, R.S.J.
HDEV-527

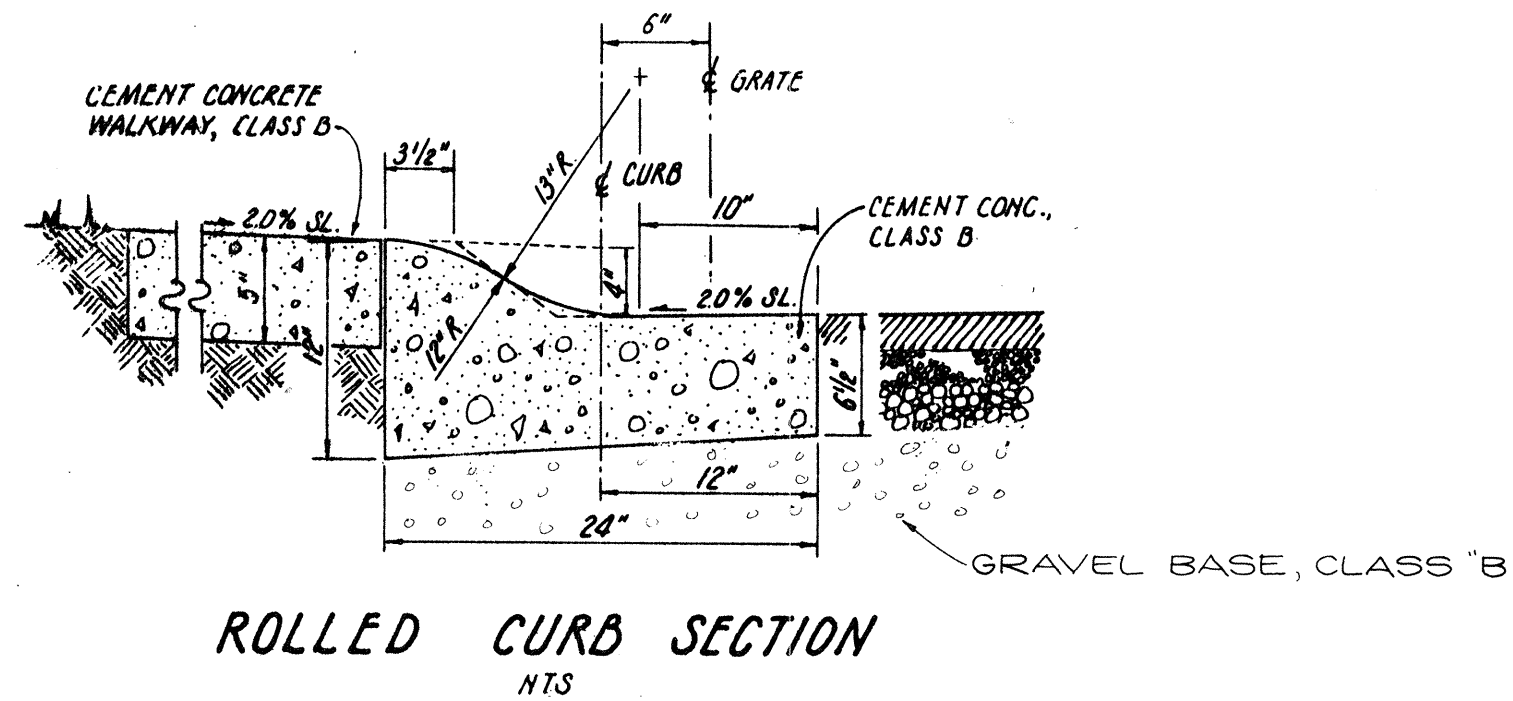

ROLLED CURB SECTION
NTS

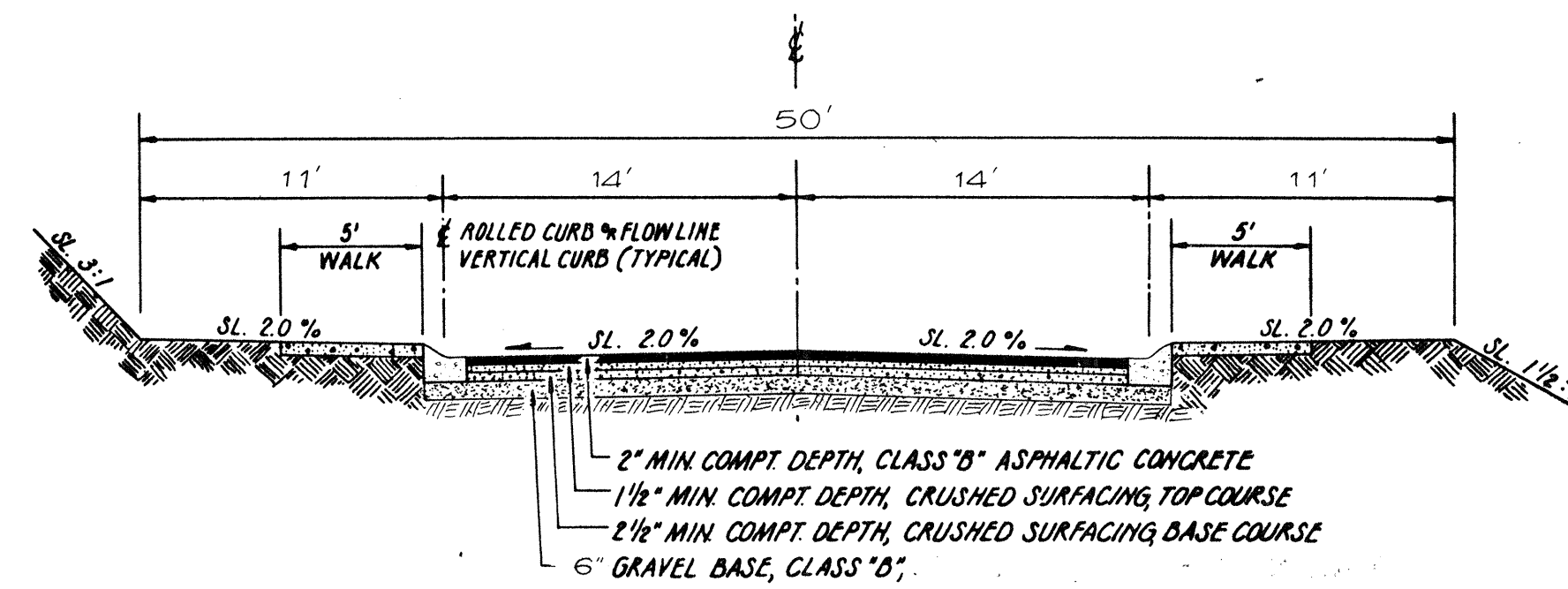

TYPICAL ROADWAY SECTION
NTS

NOTE: SIDEWALK ONE SIDE ONLY ON 14TH PL. SE.

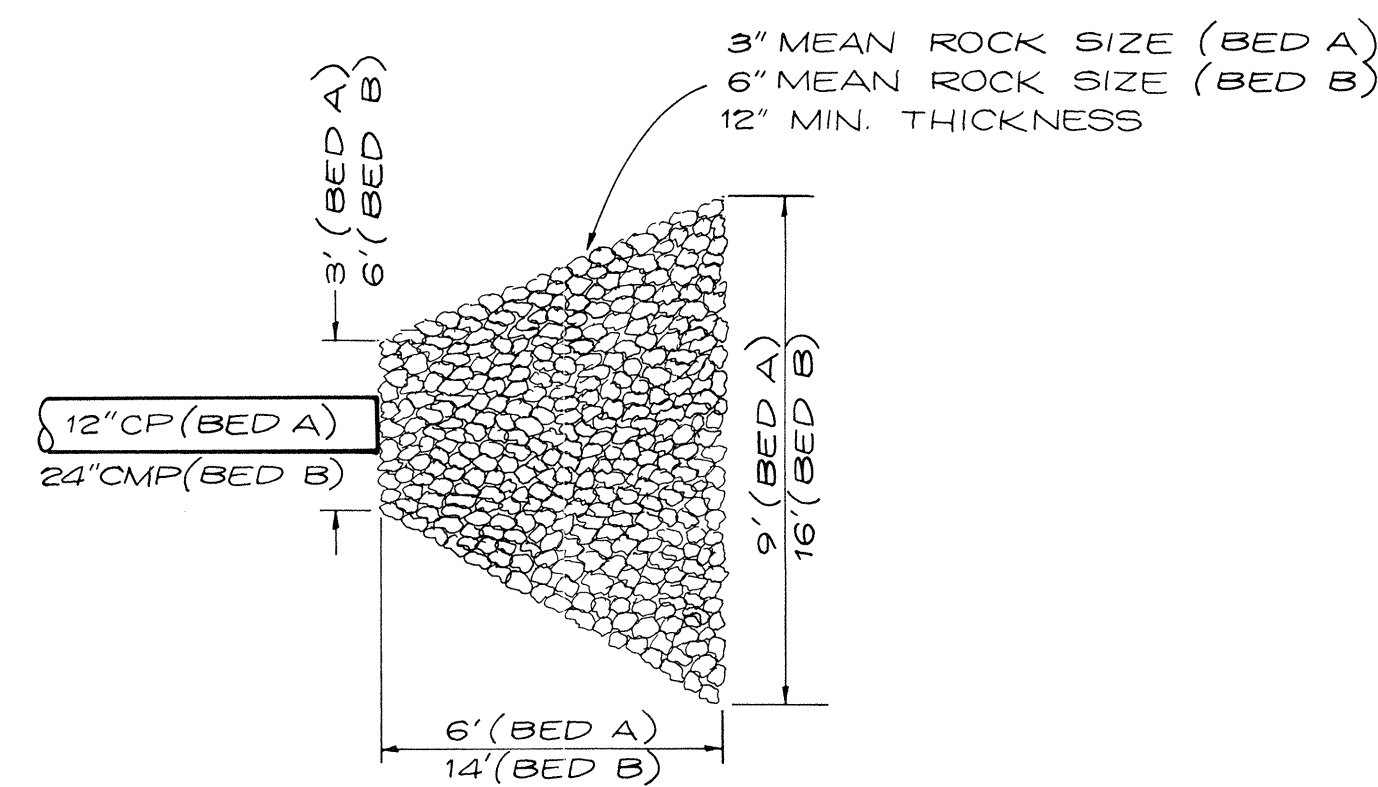

RIP-RAP BED DETAIL

GENERAL NOTES

1. ALL WORK AND MATERIALS SHALL BE IN ACCORDANCE WITH SNOHOMISH COUNTY STANDARDS AND SPECIFICATIONS.
2. LOCATIONS OF EXISTING UTILITIES AND IMPROVEMENTS SHOWN ARE APPROXIMATE ONLY AND IT SHALL BE THE RESPONSIBILITY OF THE CONTRACTOR TO DETERMINE THE EXACT LOCATION(S) OF ALL UTILITIES AND IMPROVEMENTS TO AVOID DAMAGE OR DISTURBANCE.
3. ALL WORK WITHIN THE PLAT AND COUNTY RIGHT OF WAY SHALL BE SUBJECT TO THE INSPECTION OF THE ENGINEER.
4. PRIOR TO ANY SITE WORK, THE CONTRACTOR SHALL CONTACT THE FIELD COORDINATOR FOR PLATS, UTILITIES AND DRAINAGE, AT 259-9464, TO ARRANGE FOR THE REQUIRED INSPECTIONS.
5. ALL SITE WORK OUTSIDE COUNTY RIGHT OF WAY MUST COMPLY TO CHAPTER 70 OF THE BUILDING CODE.
6. THE CONTRACTOR SHALL BE RESPONSIBLE FOR OBTAINING ALL PERMITS FOR ROAD AND UTILITY CONSTRUCTION.
7. THE TEMPORARY EROSION/SEDIMENTATION CONTROL FACILITY SHALL BE CONSTRUCTED PRIOR TO ANY GRADING OR EXTENSIVE LAND CLEARING IN ACCORDANCE WITH THE APPROVED TEMPORARY EROSION/SEDIMENTATION CONTROL PLAN. THESE FACILITIES MUST BE SATISFACTORILY MAINTAINED UNTIL CONSTRUCTION AND LANDSCAPING IS COMPLETED AND THE POTENTIAL FOR ONSITE EROSION HAS PASSED.
8. ALL STORM SEWER PIPE SHALL BE CONCRETE, NON-REINFORCED, ASTM C-14, OR CORRUGATED METAL 16 GA. GALVANIZED AND ASPHALT COATED TREATMENT 1 OR BETTER, OR CORRUGATED ALUMINUM PIPE, 16 GA. OR AASHTO M274-79 ALUMINIZED STEEL.
9. ALL PIPE SHALL BE PLACED ON STABLE EARTH, OR IF IN THE OPINION OF THE ENGINEER, THE EXISTING FOUNDATION IS UNSATISFACTORY, THEN IT SHALL BE EXCAVATED BELOW GRADE AND BACKFILLED TO GRADE WITH SAND-GRAVEL, CRUSHED STONE OR OTHER SUITABLE MATERIAL. NEVER INSTALL PIPE ON SOD, FROZEN EARTH OR LARGE BOULDERS OR ROCK.
10. THE BACKFILL SHALL BE PLACED EQUALLY ON BOTH SIDES OF THE PIPE OR PIPE-ARCH IN LAYERS WITH A LOOSE AVERAGE DEPTH OF 6", MAX. DEPTH 8", THOROUGHLY TAMPING EACH LAYER. THESE COMPACTED LAYERS MUST EXTEND FOR ONE DIAMETER ON EACH SIDE OF THE PIPE OR TO THE SIDE OF THE TRENCH. MATERIALS TO COMPLETE THE FILL OVER PIPE SHALL BE THE SAME AS DESCRIBED.
11. ALL DISTURBED SLOPES SHALL BE SEEDED WITH A PERENNIAL GROUND COVER (GRASS) TO PREVENT EROSION.
12. ALL GRATES (INLET) SHALL BE DEPRESSED 0.1 FEET BELOW PAVEMENT LEVEL.
13. ALL CATCH BASINS TO BE TYPE 1 UNLESS OTHERWISE NOTED.
14. THE CONTRACTOR SHALL BE RESPONSIBLE FOR ADJUSTING ALL MANHOLE, INLET, AND CATCH BASIN FRAMES AND GRATES JUST PRIOR TO POURING OF CURBS.
15. ALL CATCH BASINS WITH A DEPTH OVER 5.0 FEET TO THE FLOWLINE SHALL BE TYPE II CB'S (MANHOLE).
16. MAILBOXES SHALL BE CONSTRUCTED TO SNOHOMISH COUNTY STANDARDS. (SEE SNOHOMISH COUNTY STANDARD DRAWING NO. B-7).
17. ALL FILLS SHALL BE COMPACTED TO A MINIMUM OF 95% OF MAXIMUM DENSITY.
18. CP INDICATES CONCRETE PIPE WILL BE REQUIRED; CMP INDICATES CORRUGATED METAL PIPE MAY BE USED INSTEAD OF CONCRETE PIPE.
19. PRIOR TO SIDEWALK CONSTRUCTION, THE ENGINEER WILL EVALUATE INDIVIDUAL LOT DRAINAGE AND DIRECT THE INSTALLATION OF CATCH BASIN STUB OUTS AND PERFORATED PIPE AS REQUIRED. LOCATIONS FOR THESE INSTALLATIONS SHALL BE PLACED ON THE AS-BUILT CONSTRUCTION PLANS AND SUBMITTED TO THE COUNTY.

DETAILS
FOR
THE VILLAGE GREEN
IN SW1/4 OF NE 1/4, SECTION 31, T.28 N., R.5 E., W.M.
SNOHOMISH COUNTY, WASHINGTON

Robert J. ...

HDEV-528

PER COUNTY REVIEW		5-22-84		RCN	
Lovell-Sauerland & Associates, Inc.					
SURVEYORS		DEVELOPMENT CONSULTANTS		PLANNERS	
23106 100TH AVE. W.		EDMONDS WA 98020		PHONE 775-1591	
DRAWN	CHECKED	DATE	F.B.	SCALE	FILE NO.
RCN	RSJ	11-30-83	191	NONE	83-1062